

**P&Z**  
PZ21-13000002  
8/25/2021

LANDSCAPE AREAS SCHEDULE			
SYMBOL	DESCRIPTION	QTY	PERCENTAGE
1-PA	Pervious Area	12,258 sf	15 %
2-IA	Impervious Area	65,194 sf	83 %
3-VA	Vehicular Use Area	1,608 sf	2 %

LANDSCAPE AREAS SCHEDULE (INCLUDING DUNES)			
SYMBOL	DESCRIPTION	QTY	PERCENTAGE
1-PA	Pervious Area	51,861 sf	43 %
2-IA	Impervious Area	65,194 sf	55 %
3-VA	Vehicular Use Area	1,608 sf	2 %

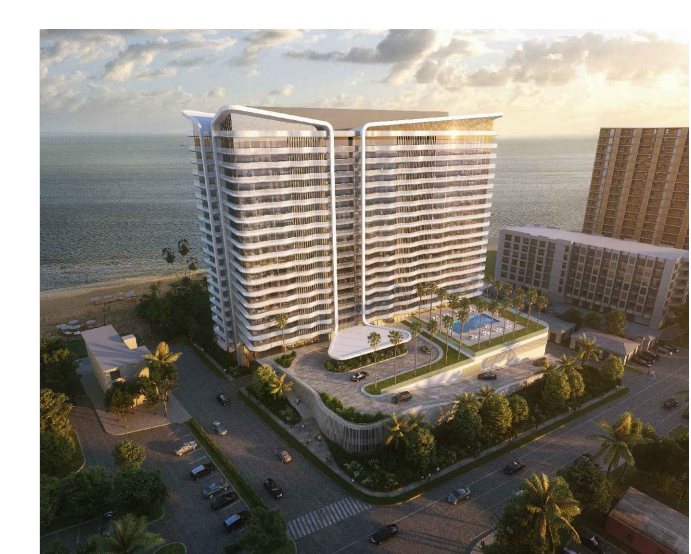

900 N OCEAN

POMPANO BEACH, FLORIDA

OWNER:  
PRH 900 NORTH OCEAN, LLC

**ARQUITECTONICA**  
2900 Oak Avenue  
Miami, Florida 33133  
Tel: (305) 372-1612  
www.arquitectonica.com

**KEITH**  
301 E Atlantic Blvd.  
Pompano Beach, Florida 33060  
Tel: (954) 788-3400  
www.keithteam.com

STRUCTURAL ENGINEER:  
TBD.

MEP ENGINEER:  
TBD.

**ARGEO**  
2900 Oak Avenue  
Miami, Florida 33133  
Tel: (305) 372-1612  
www.arquitectonica.com

SEAL/SIGNATURE/DATE:

Alejandro Javier Perez  
Digitally signed by Alejandro Javier Perez  
Date: 2021.05.28 11:18:29 -04'00'

DRC SUBMITTAL		
28 APRIL, 2021		
ISSUE #	DESCRIPTION	DATE
01	PRE-APP	01/27/2021
02	DRC	03/18/2021
03	DRC	05/26/2021

PROJECT NUMBER:

ALL DESIGNS INDICATED IN THESE DRAWINGS ARE THE PROPERTY OF ARQUITECTONICA INTERNATIONAL CORP. ALL COPYRIGHTS RESERVED 2021. NO COPIES, TRANSMISSIONS, REPRODUCTIONS OR ELECTRONIC MANIPULATION OF ANY PORTION OF THESE DRAWINGS IN WHOLE OR IN PART ARE TO BE MADE WITHOUT THE EXPRESS WRITTEN PERMISSION OF ARQUITECTONICA INTERNATIONAL CORP.

DRAWING NAME: **LANDSCAPE CALCULATIONS**

**P&Z**  
PZ21-13000002  
8/25/2021

©2021 ARQUITECTONICA INTERNATIONAL, Inc.  
Office: Pompano Beach, FL 33060